

GH4 - GH4A
GH4LIVE
GH4M

4" High Performance Full Range Speaker - Mini Array Element - Passive or Active

4" High Performance Full-Range Speaker with SpeakON connectors - Passive

4" High Performance Full-Range Speaker - passive 16 Ω - with marine treatments



GH4 Series

The GH4 is a compact, high-performance satellite speaker with a 4" full-range driver, dual-coil neodymium magnet, and variable impedance (4-16 Ω). Its cabinet design reduces rear emission for better sound control and efficiency.

The stainless steel enclosure (IP64) ensures durability in tough conditions and can reach IP65 with the G-IPCAP1 accessory. GH4 is perfect for fixed installations in hospitality, entertainment, theaters, broadcast, HOW, and residential spaces.

Supplied with the GF-WALL bracket, it also supports optional GH4-JOINT and GH4-FLY accessories for arrays or suspended setups.

GH4A - Active

The GH4A adds a built-in amplifier module with balanced input, mute contact, and auto ON/OFF function. A power output allows driving one additional GH4 (min. 4 Ω), making it a compact all-in-one solution.

GH4LIVE - Live Events

The GH4LIVE is optimized for touring and live events, featuring SpeakON NL4 connectors for fast, reliable setup and easy system integration.

GH4M - Marine

The GH4M is built for marine and extreme outdoor environments, with an integrated multipolar cable and watertight gland. Its IP65 rating ensures long-term resistance to water and humidity.

Mechanical Drawings GH4 - GH4A

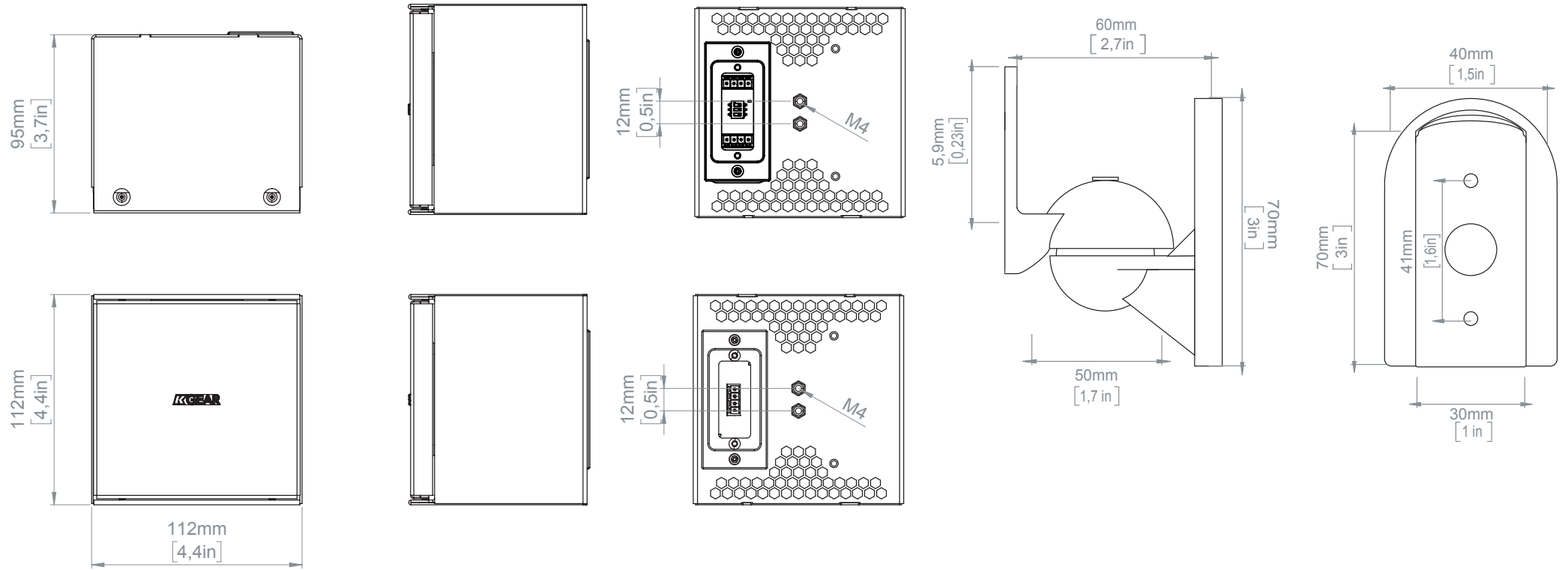

Mechanical Drawings - GH4LIVE

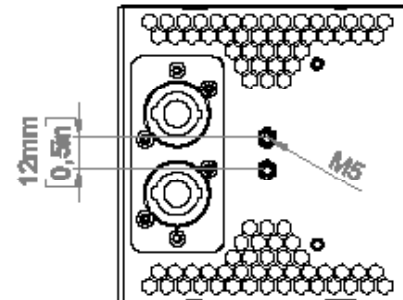
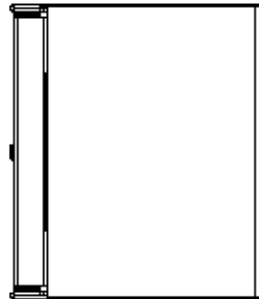
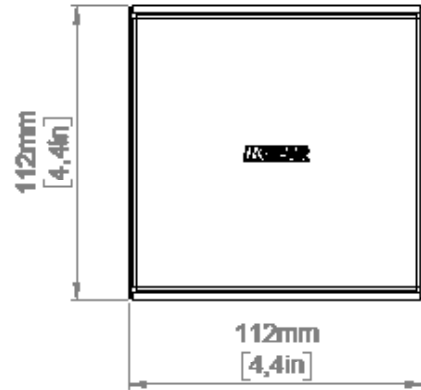
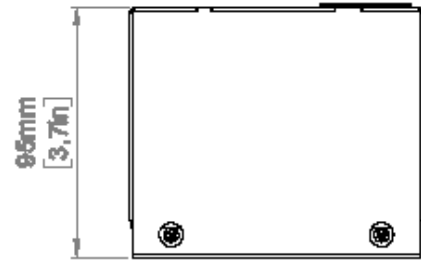

Mechanical Drawings GH4M - Marine

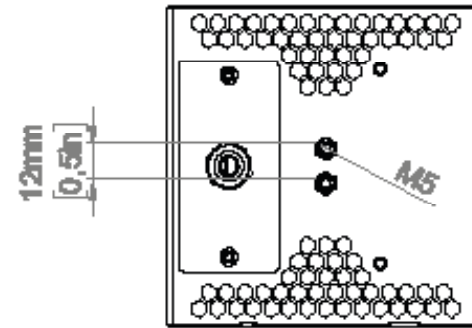
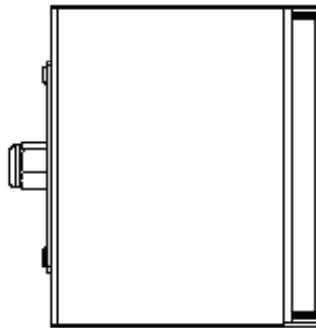
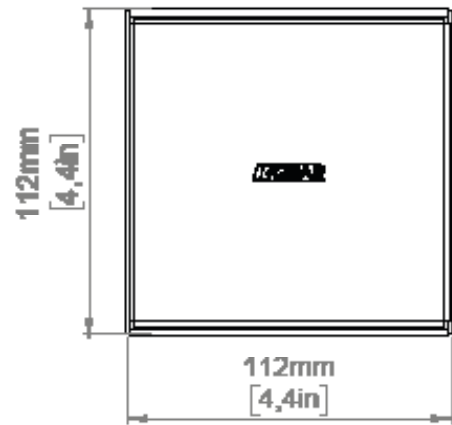

Mounting Accessories GH4-JOINT - GH4-FLY for arraying configuration (recommended)

Using these accessories you can have a complete gear for array mounting GH4 in vertical, first joining multiple speakers together with GH4-JOINT, then setting different inclination and regulate the dispersion angle, thanks to GH-FLY adjustable bracket (this hardware supports up to 8 GH4 speakers in array configuration)

You can choose GH4-WALL bracket to fix the array to walls. These accessories are not included in the package but are recommended for specific use.

G-IPCAP1(not included)

GH4 and GH4A can be protected against foreign agents, salt, chlorine and water using the G-IPCAP1. This is a dedicated IP sealing CAP made by highly resistant and tight rubber, thought to be mounted at the rear panel of the speaker to protect connectors and ensure IP-64 protection.



GH4-JOINT



GH4-FLY



GH4

Technical specifications
Type Passive loudspeaker
Transducer 4" neodymium magnet full range driver
Frequency Response ¹ 150 Hz - 20 kHz (-6dB)
Max SPL ² 122 dB Peak
Power Handling 140 W
Coverage V.90 H.90°
Connectors 1x Phoenix connector (4-pin Euroblock)
Nominal Impedance 4 Ω - 16 Ω selectable
IP Rating ³ IP64
Handling & Finishes
Dimensions (WxLxH) 112 x 112 x 95 mm (4.4 x 4.4 x 3.70 in)
Weight 1,2 kg (2.65 lb)
Material Stainless Steel
Color Black

¹ With dedicated preset

² Maximum SPL is calculated using a signal with crest factor 4 (12 dB) measured at 8 m then scaled at 1 m

³ With dedicated sealing accessory G-IPCAP1

GH4A

Technical specifications
Type Active loudspeaker
Transducer 4" neodymium magnet full-range driver
Frequency Response ¹ 150 Hz - 20 kHz (-6dB)
Max SPL ² 116 dB (peak)
Coverage V.90 H.90°
Connectors 2x Phoenix connector (4-pin euroblock) Balanced line in Mute Contact Power out 24V DC IN (power supply not included)
Controllers Auto ON/OFF with selectable threshold
Amp Module 1-channel Class D amplifier
Output Power 100W @ 2 Ω (24V power)
Power Consumption 30W Power Load 1/8 Max Power
Protections Thermal Protections (Power-Limiting - Thermal Shutdown) Short - circuit/overload output protections
Operating Range 12-24 V DC
IP Rating IP64
Handling & Finishes
Dimensions (WxLxH) 112 x 112 x 95 mm (4.4 x 4.4 x 3.70 in)
Weight 1,2 kg (2.65 lb)
Material Stainless Steel
Color Black

¹ With dedicated preset

² Maximum SPL is calculated using a signal with crest factor 4 (12 dB) measured at 8 m then scaled at 1 m

GH4M

Technical specifications
Type Passive loudspeaker
Transducer 4" neodymium magnet full range driver
Frequency Response ¹ 150 Hz - 20 kHz (-6dB)
Max SPL ² 122 dB Peak
Rated Power 140 W
Coverage V.90 H.90°
Connectors Multipole cable with sealing cable gland and wago connectors
Nominal Impedance 16 Ω
IP Rating IP65
Handling & Finishes
Dimensions (WxLxH) 112 x 112 x 95 mm (4.4 x 4.4 x 3.7 in)
Weight 1,2 kg (2.65 lb)
Material Stainless Steel
Color Black

¹ With dedicated preset

² Maximum SPL is calculated using a signal with crest factor 4 (12 dB) measured at 8 m then scaled at 1 m

GH4LIVE

Technical specifications
Type Passive loudspeaker
Transducer 4" neodymium magnet full range driver
Frequency Response ¹ 150 Hz - 20 kHz (-6dB)
Max SPL ² 122 dB (peak)
Power Handling 140 W
Coverage V.90 H.90°
Connectors 2x SpeakON NL4 1+ 1- (signal) 2+ 2- (trough)
Nominal Impedance 16 Ω
IP Rating IP64
Handling & Finishes
Dimensions (WxHxD) 112x 112x 95mm (4.4x 4.4x 3.7 in)
Weight 1,2 kg (2.87 lb)
Material Stainless Steel
Color Black

¹ With dedicated preset

² Maximum SPL is calculated using a signal with crest factor 4 (12 dB) measured at 8 m then scaled at 1 m

GH4R - GH4RT

4" High Performance Full Range Speaker - recessed - recessed with transformer



The iconic GH4 4" full-range speaker, which has astonished everyone over the years with its incredible performance in such a compact form, now gains a sibling in a recessed version. GH4R comes with features that make it even more suitable for outdoor installations and demanding environments. Encased in a fully sealed stainless steel little cabinet easily recessed and equipped with a removable magnetic grille treated to withstand the harshest conditions, just to name a few examples, this version exemplifies installations.

The flexibility and compactness of GH4R make it a great choice for fixed installation in a wide array of applications from hospitality, to transportation, corporate and residential.

GH4RT has a built-in transformer that offers various power taps, providing flexibility for different setups: 64/32/16/8 W @100V - 32/16/8/4 W 70V. This makes it effortless to connect multiple speakers in parallel with high power and efficiency while allowing for individualized output levels.

The GH4RT seamlessly integrates with high voltage lines, making it suitable for a variety of applications, including transportation facilities, corporate environments, and more.

Mechanical Drawings

GH4R

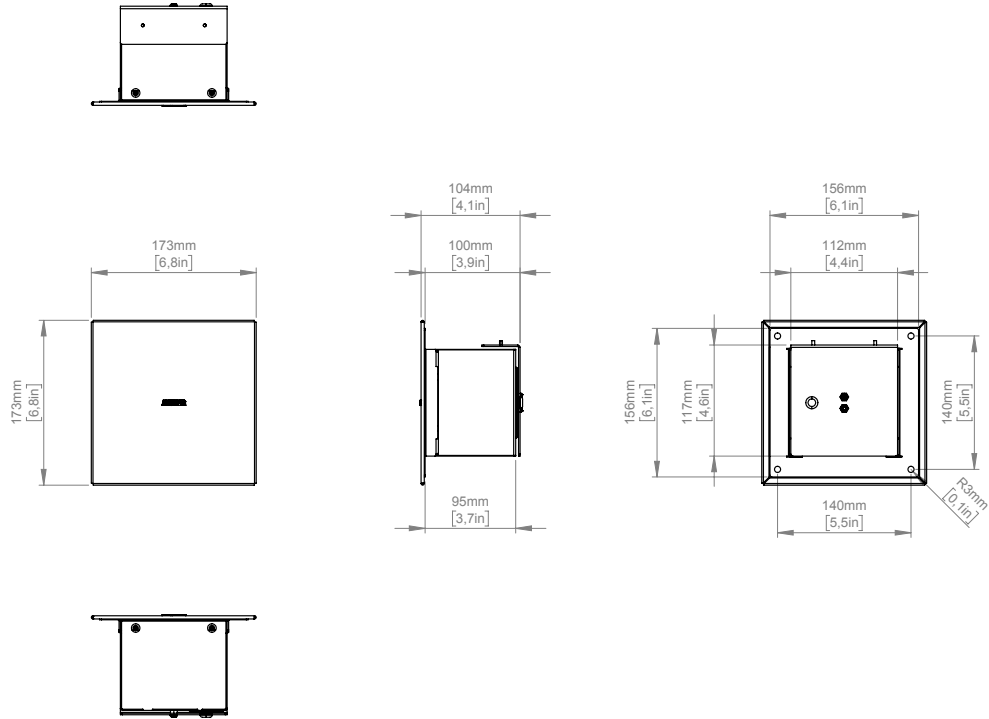

GH4RT

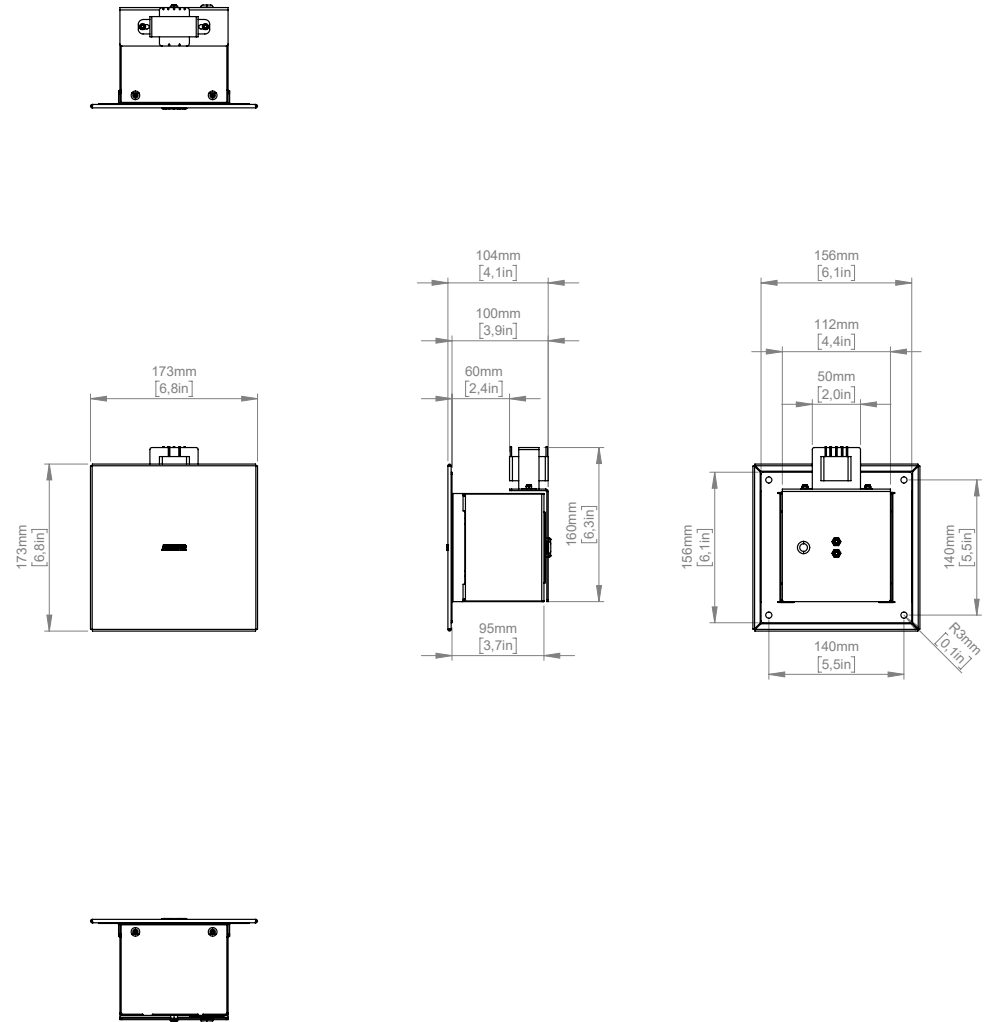

GH4R

Technical specifications
Type Passive loudspeaker
Transducer 4" neodymium magnet full-range dual cone transducer
Frequency Response ¹ 150 Hz - 20 kHz (-6dB)
Max SPL ² 122 dB Peak
Power Handling 140 W
Coverage V.90 H.90°
Connectors 1x Phoenix connector (4-pin Euroblock)
Nominal Impedance 16 Ω selectable
IP Rating IP64
Handling & Finishes
Dimensions (WxLxH) 173 x 173 x 104 mm (6.8 x 6.8 x 4.1 in) - center distance 140x140x140mm (5.5x5.5x5.5 in)
Weight 1,2 kg (3,7 lbs)
Material Stainless Steel
Color Black

¹ With dedicated preset

² Maximum SPL is calculated using a signal with crest factor 4 (12 dB) measured at 8 m then scaled at 1 m

GH4RT

Technical specifications
Type Passive loudspeaker with built-in transformer
Transducer 4" neodymium magnet full range driver
Frequency Response ¹ 150 Hz - 20 kHz (-6dB)
Max SPL ² 122 dB Peak
Transformer power Taps: 64/32/16/8 W @100V - 32/16/8/4 W 70V
Coverage V.90 H.90°
Connectors 1x Phoenix connector (4-pin Euroblock)
Nominal Impedance 16 Ω
IP Rating IP64
Handling & Finishes
Dimensions (WxLxH) 173 x 173 x 104 mm (6.8 x 6.8 x 4.1 in) - center distance 140x140x140mm (5.5x5.5x5.5 in) - transformer dimension 50mm (2,0in)
Weight 1,7 kg (3,7 lbs)
Material Stainless Steel
Color Black

¹ With dedicated preset

² Maximum SPL is calculated using a signal with crest factor 4 (12 dB) measured at 8 m then scaled at 1 m